

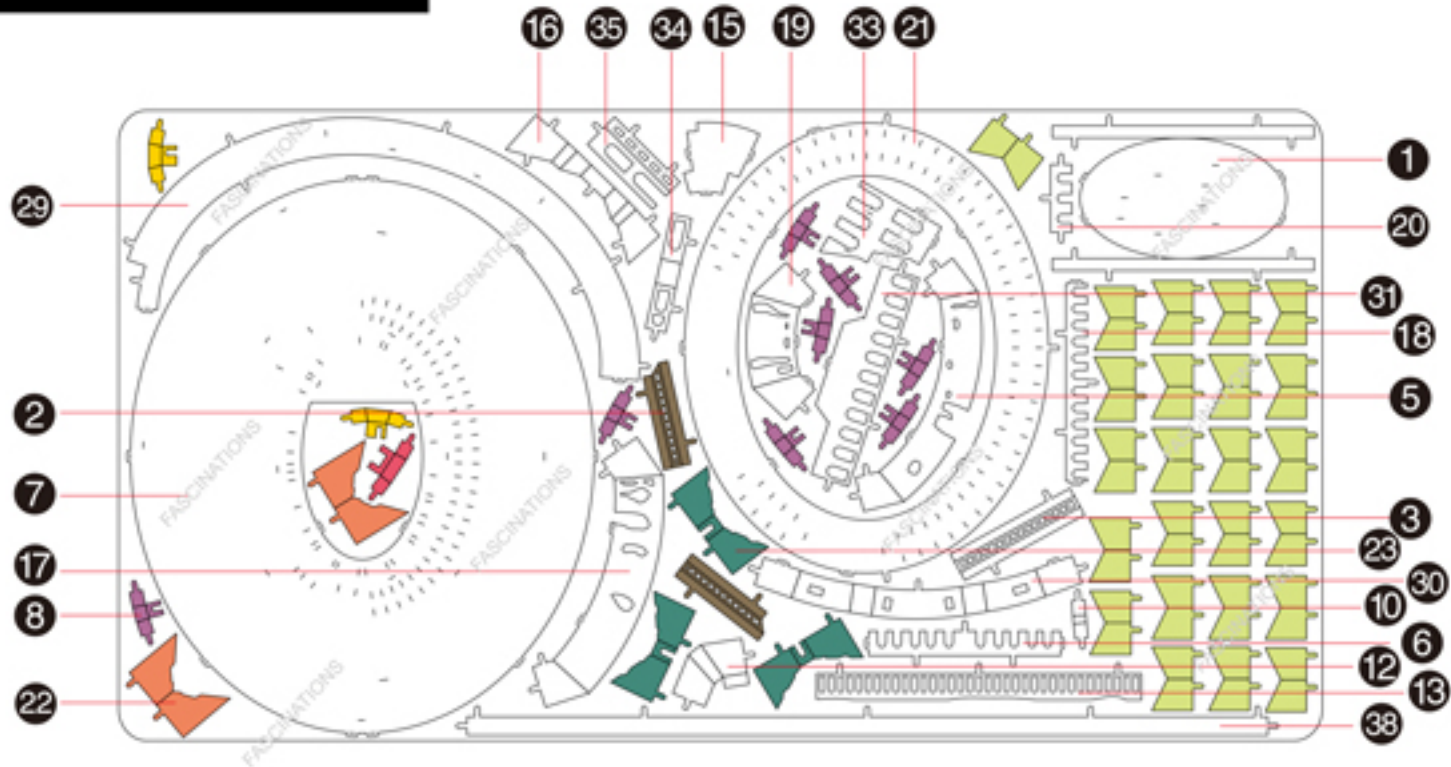

It is highly recommended that you visit [www.metalearth.com/360/icx025](http://www.metalearth.com/360/icx025) to see the completed model before assembling your own

3D METAL MODEL KITS

## METAL SHEET 1



## METAL SHEET 2

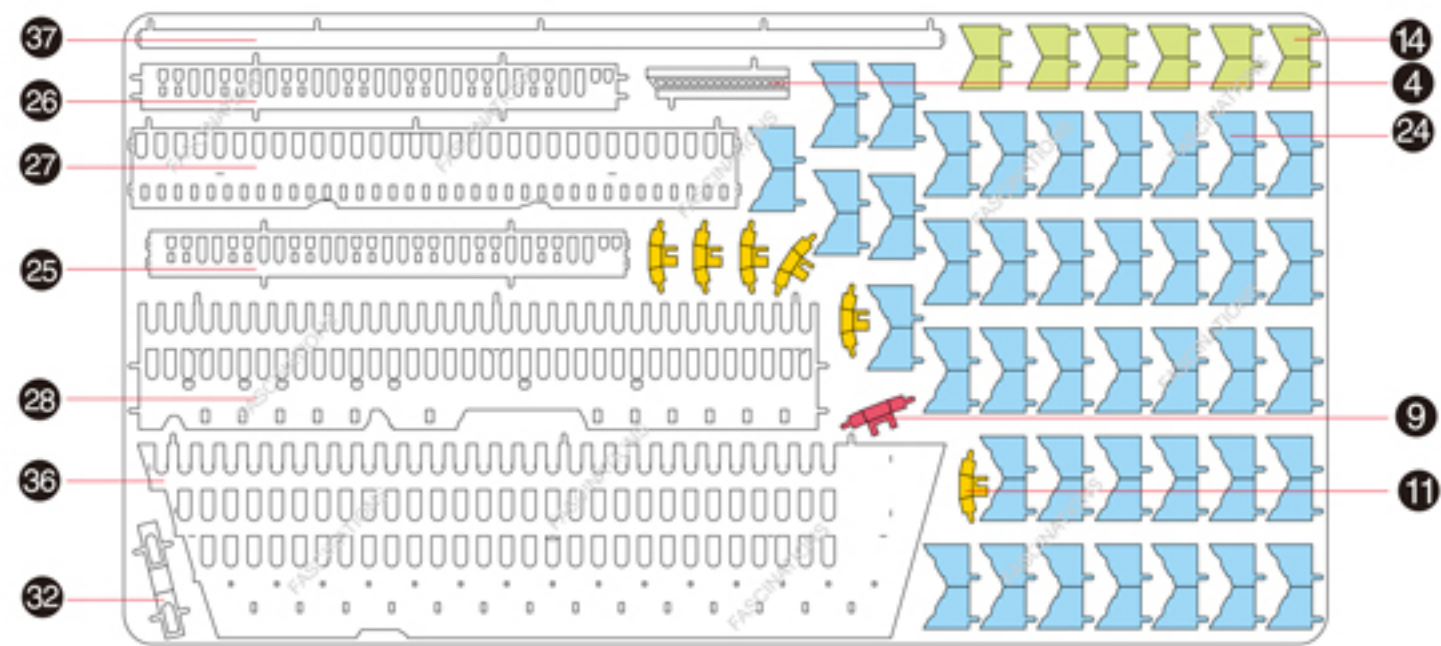

In order to avoid possible injury from sharp edges, please carefully discard the metal sheets after parts have been removed.

## ICX025



## Roman Colosseum Ruins

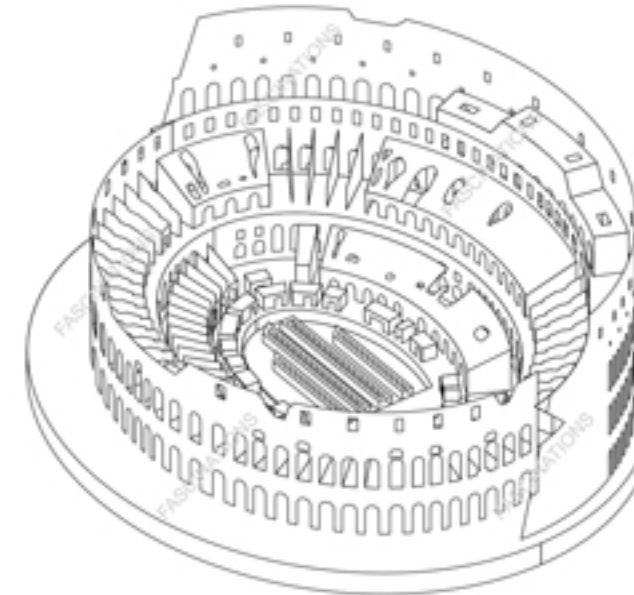

## TO CREATE THE BEST CONNECTIONS

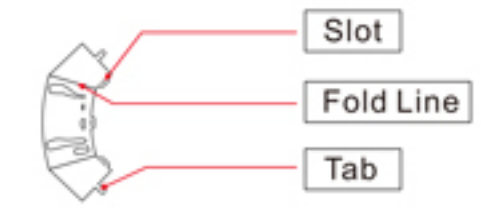

### Legends:

- Engraved side
- Non-engraved side
- Attention point
- Insert tab and bend 90 degrees
- Insert tab and twist 90 degrees

### Recommended tools:

-Wire cutters: helpful for taking parts from the metal sheets.



-Tweezers or needle nose pliers: helpful for folding parts, bending and twisting tabs.



### Assembly tip:

If needed, slightly twist tabs to hold parts together then untwist and bend them down for a nice finish

## ASSEMBLY STEPS

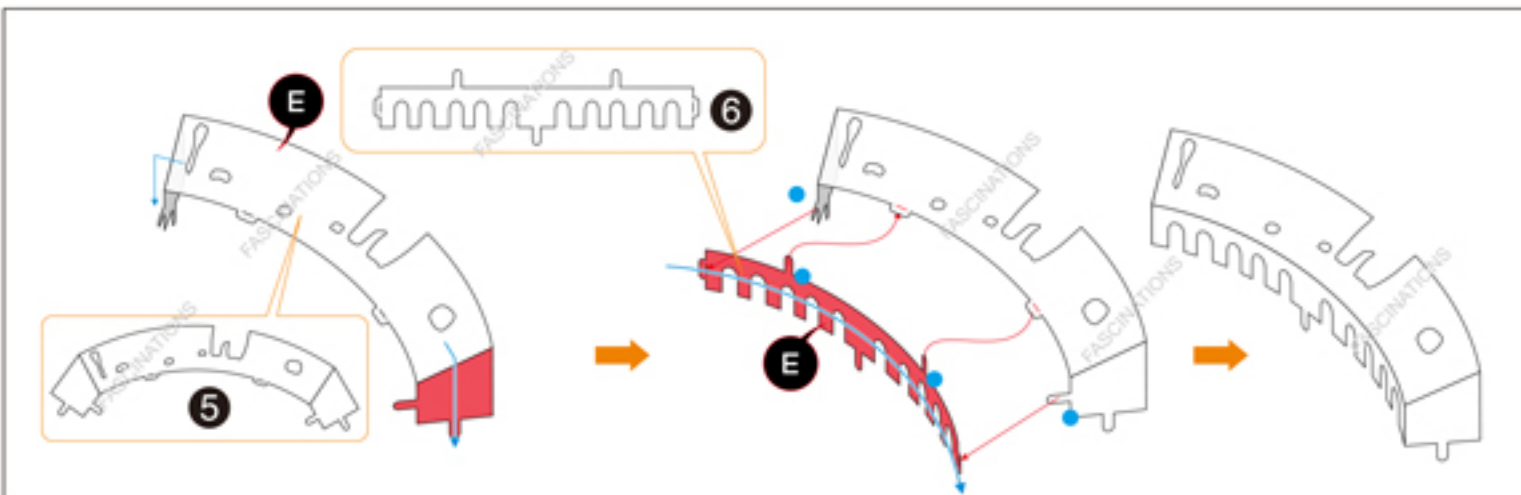
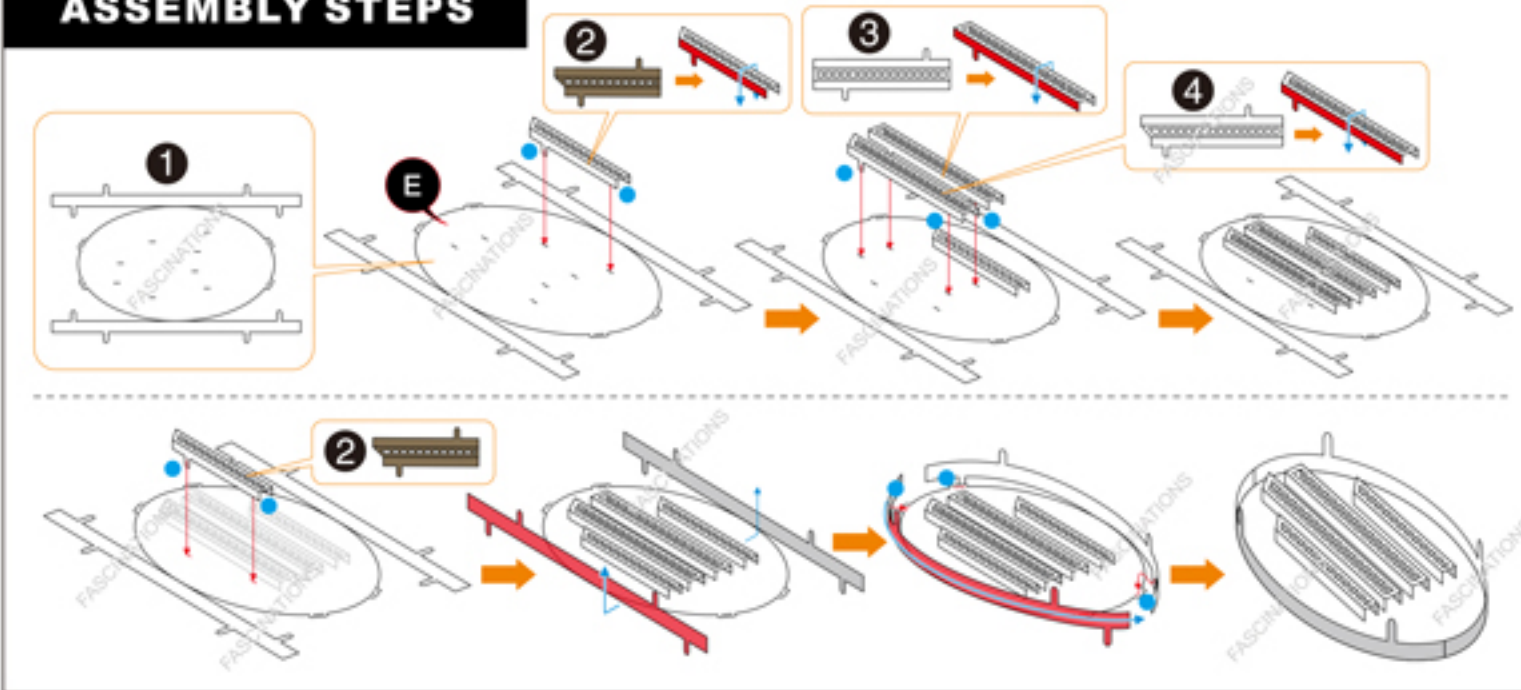



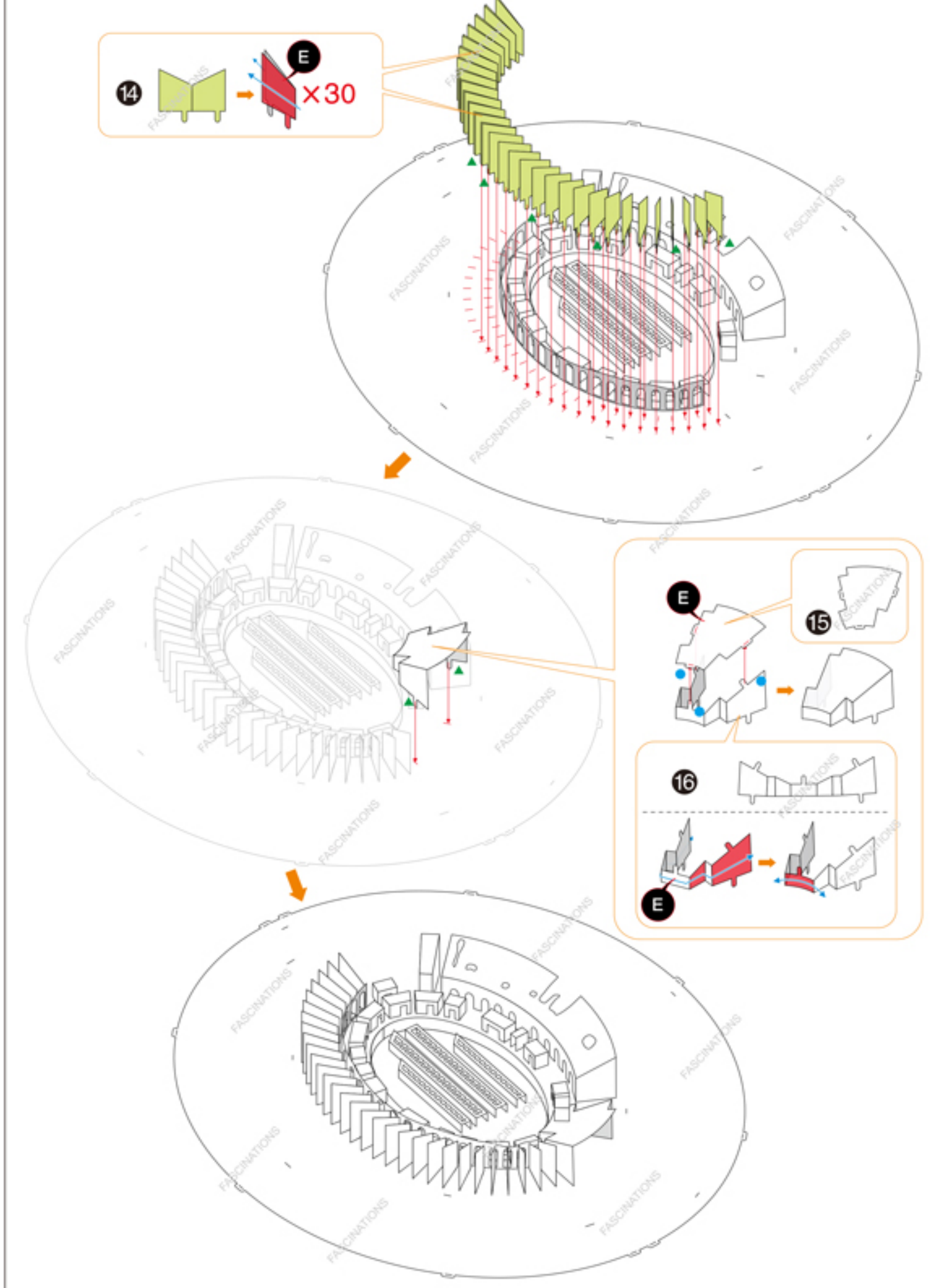
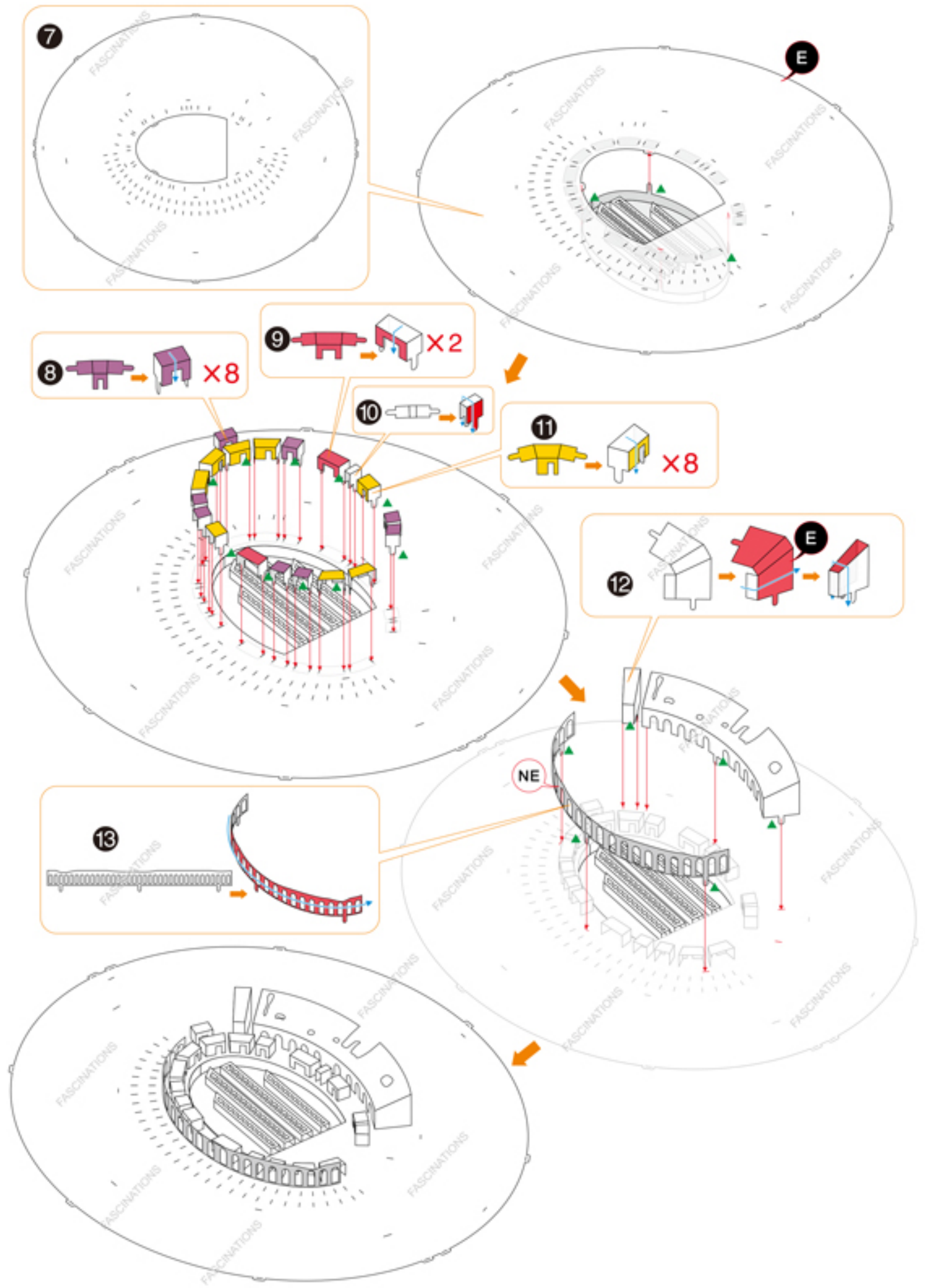



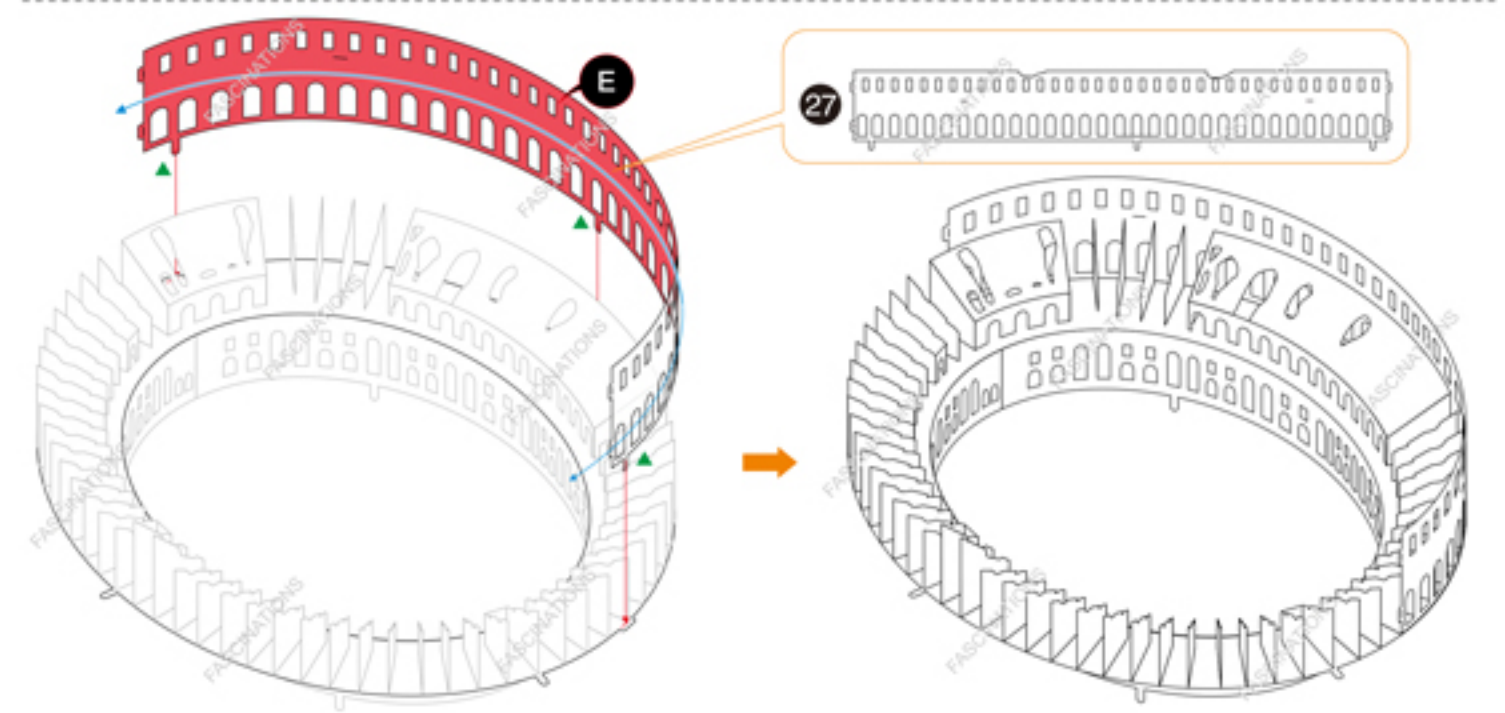
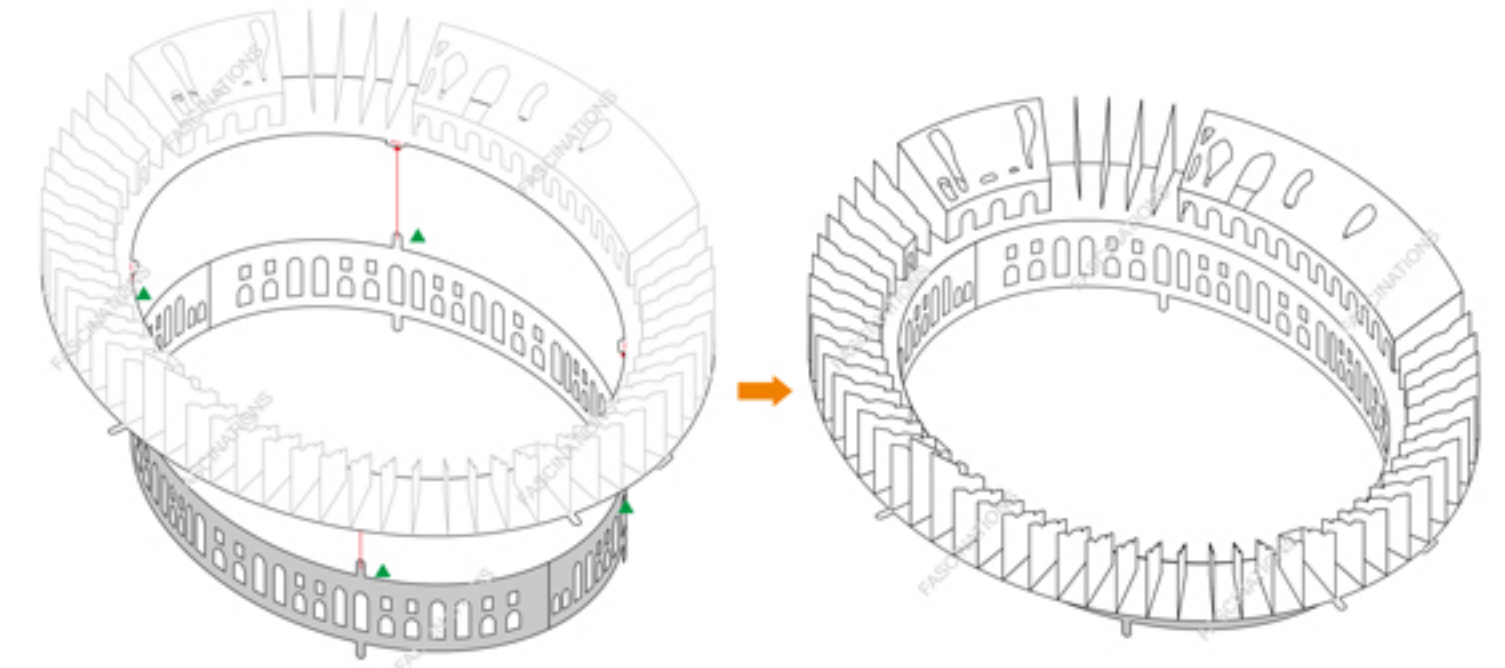
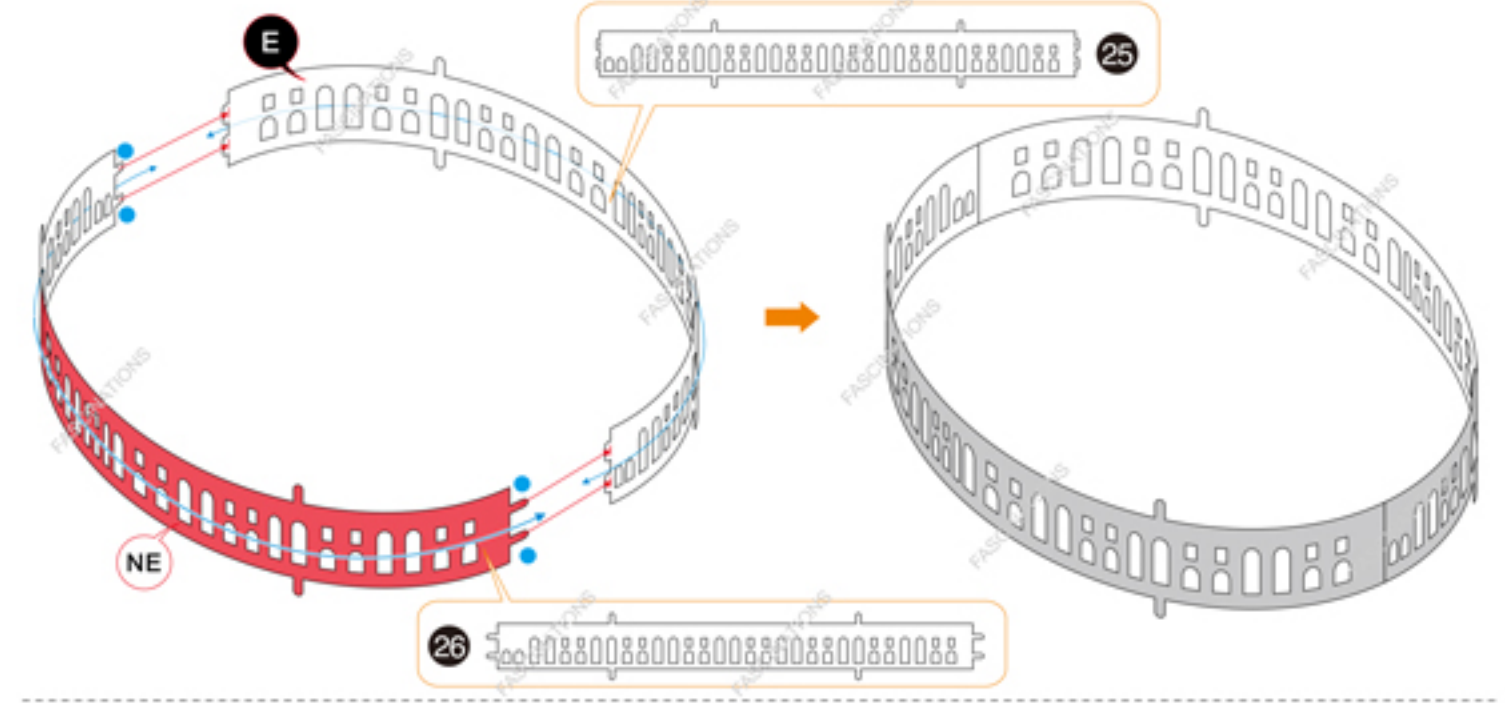
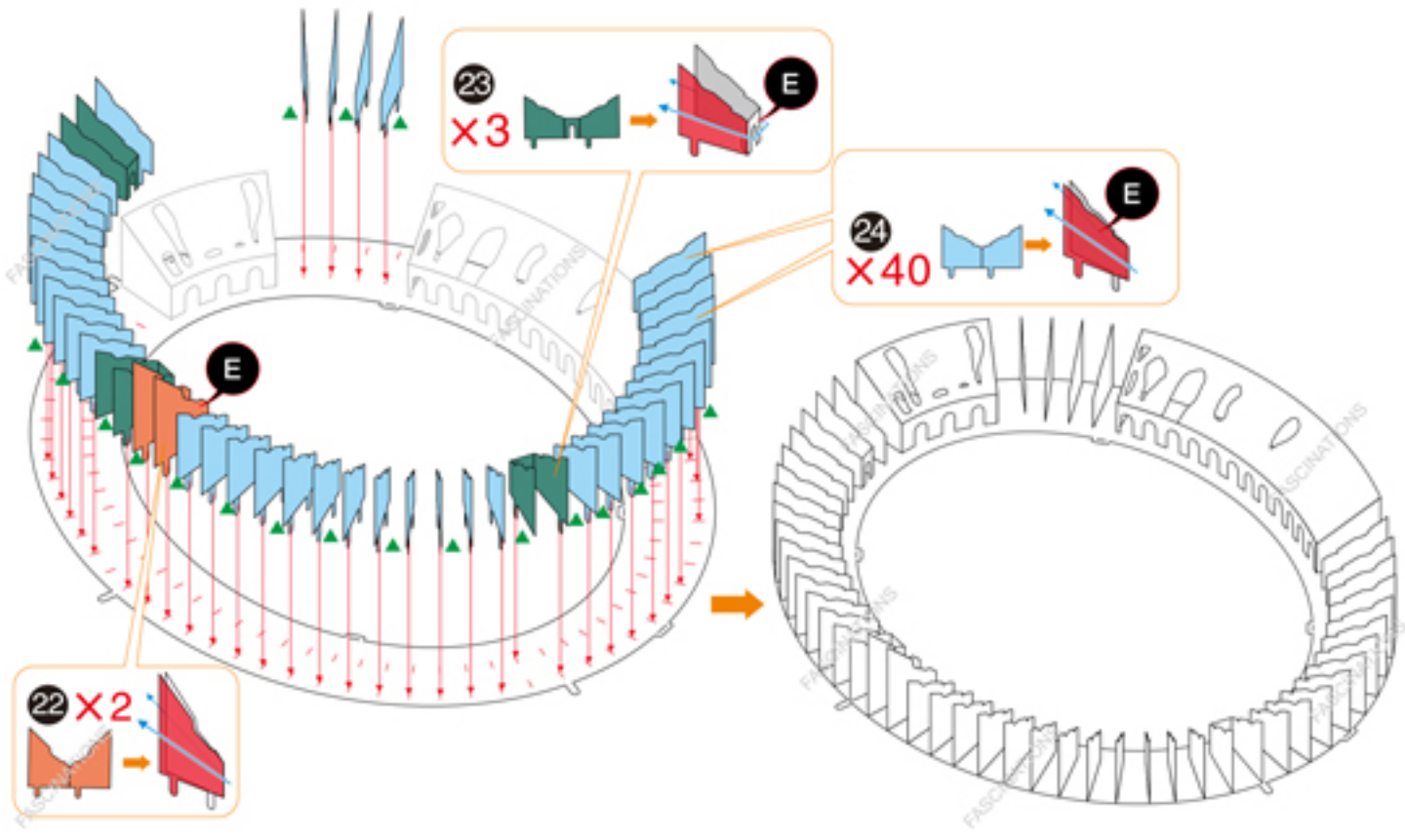
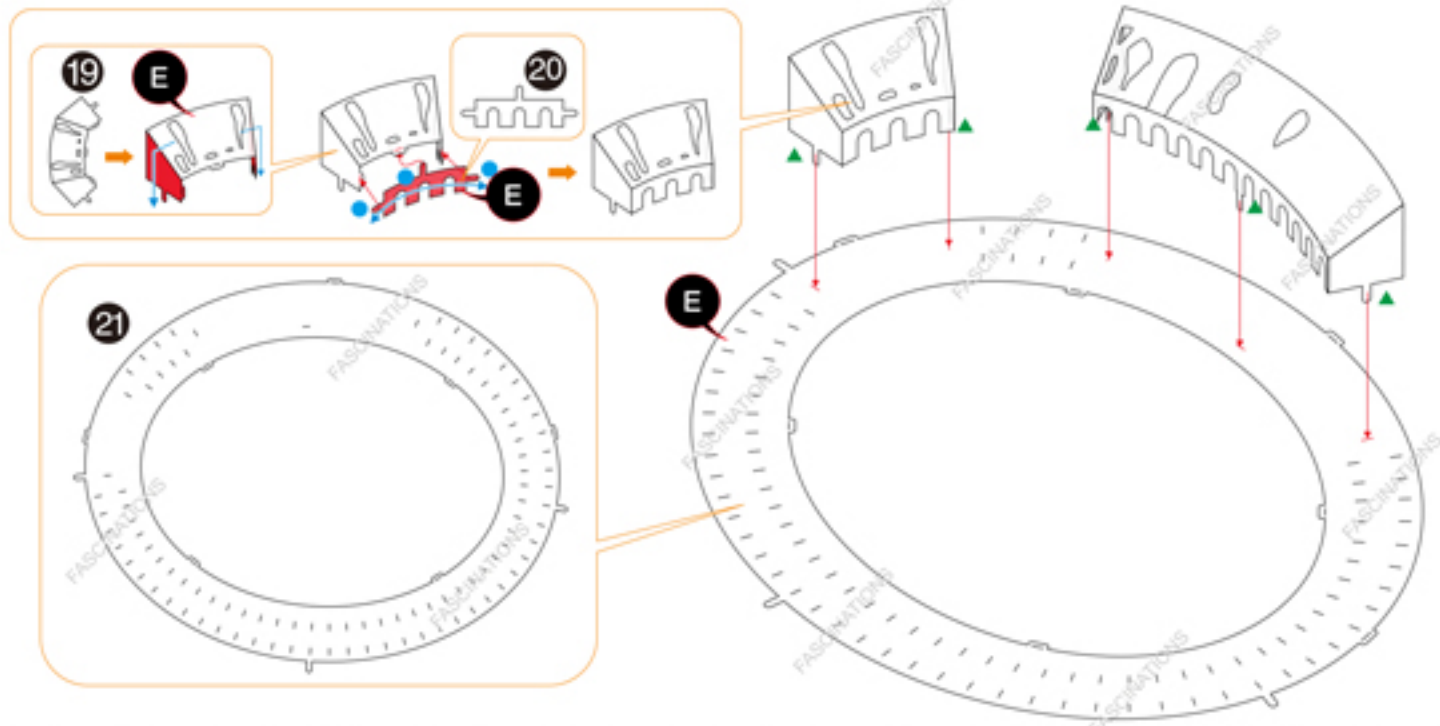
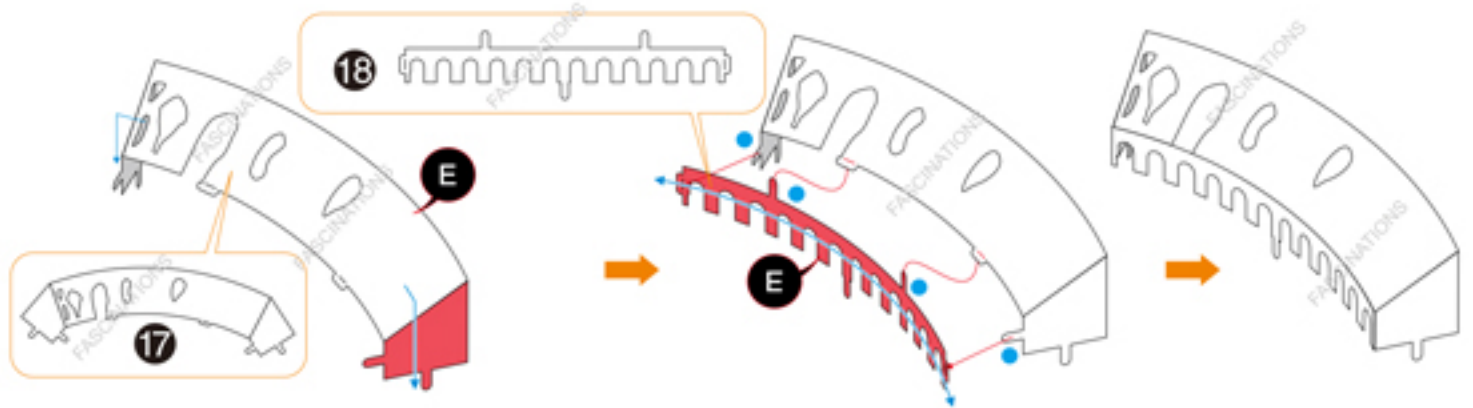



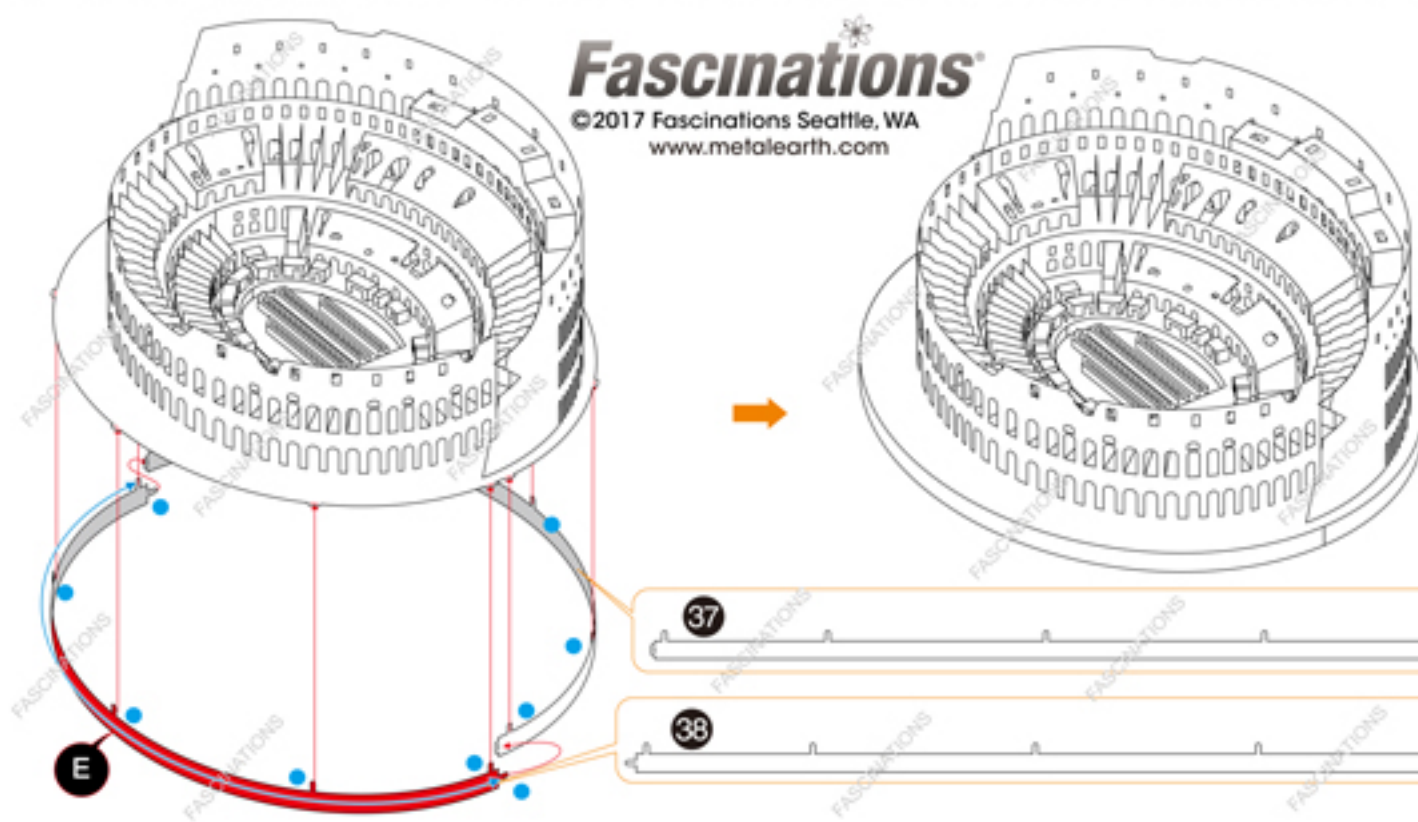
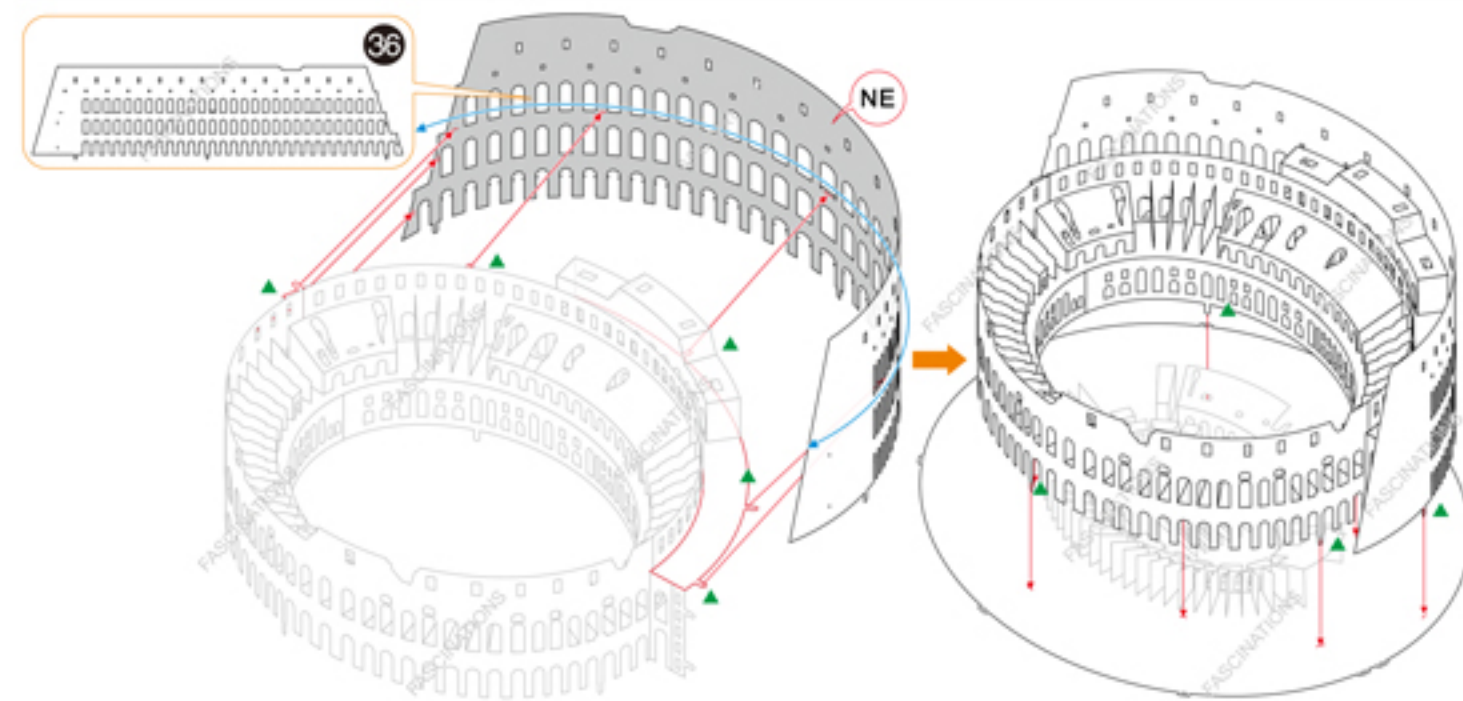
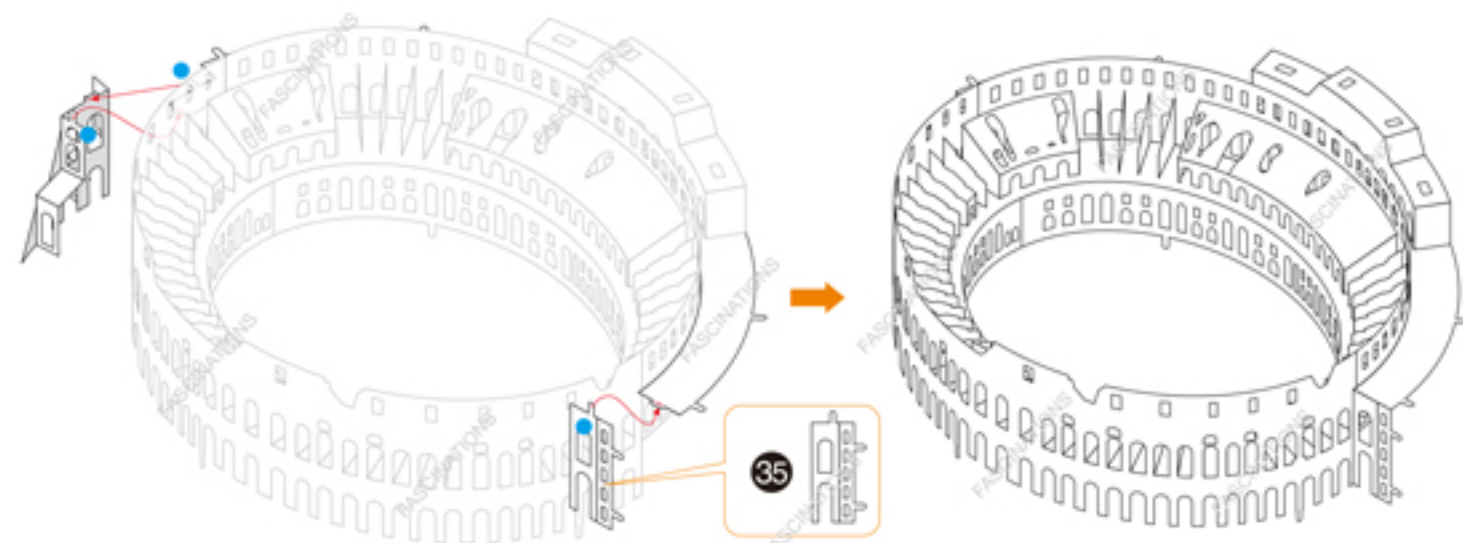
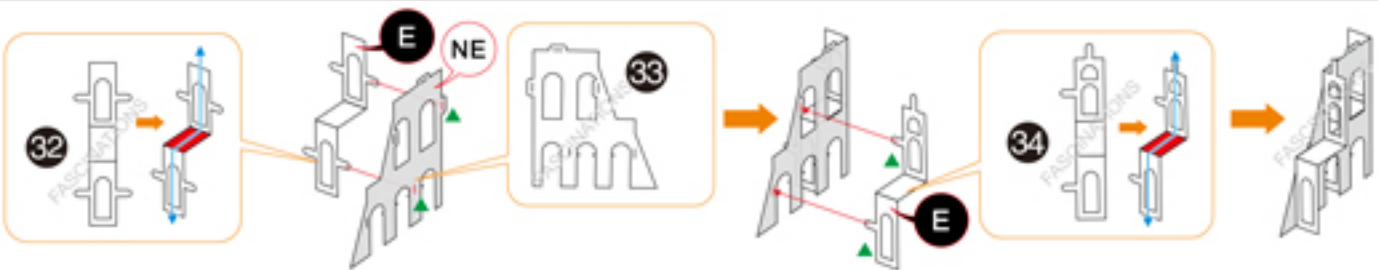
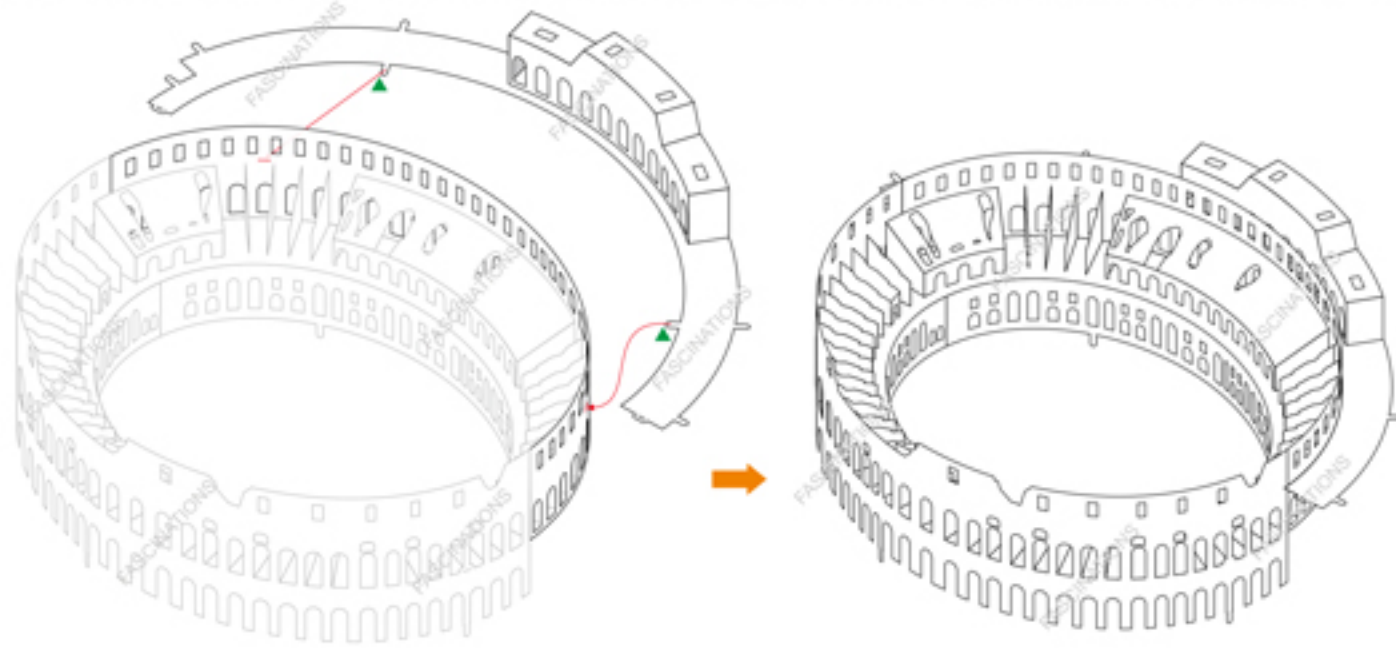
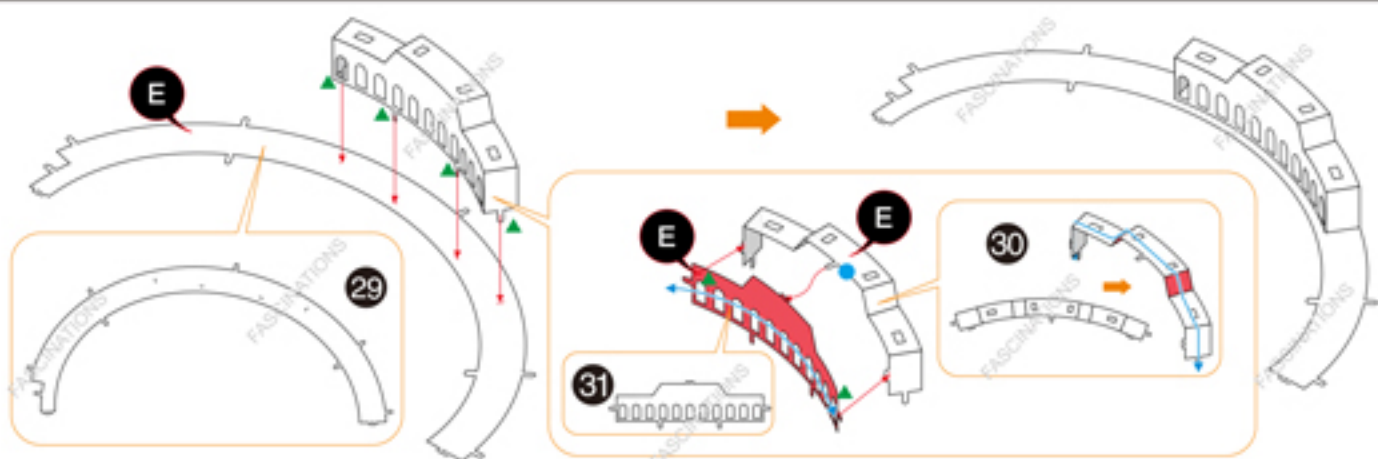
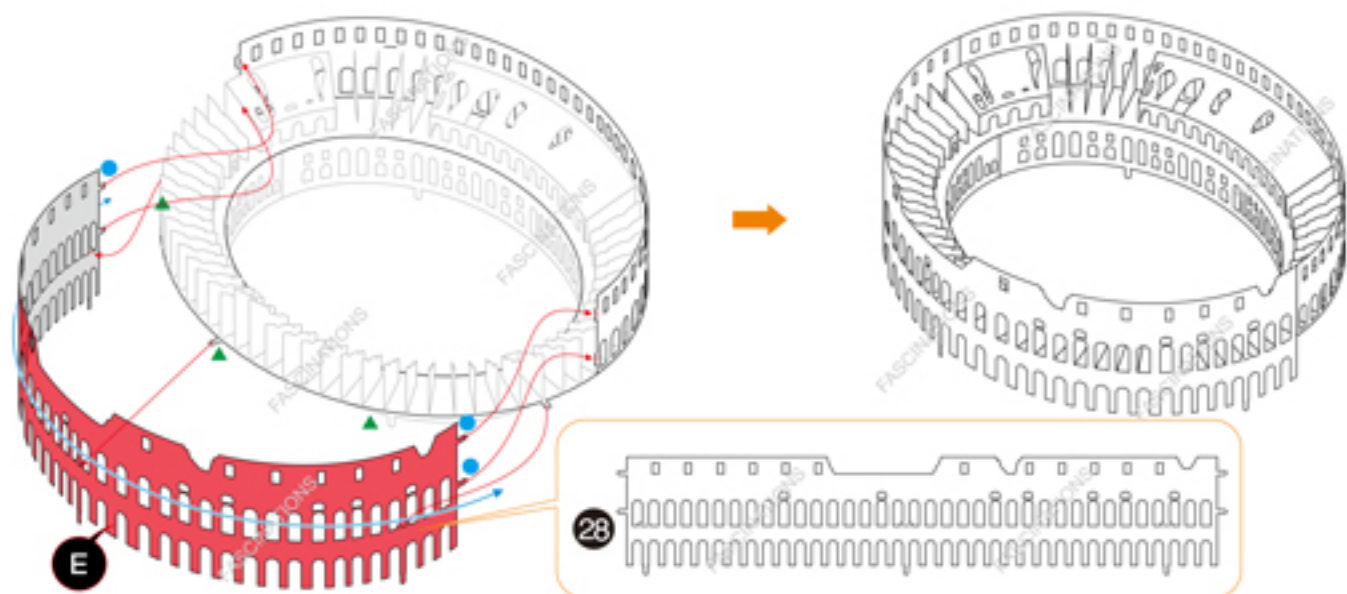

**Fascinations**  
 ©2017 Fascinations Seattle, WA  
 www.metalearth.com